



The Bike Shield Assembly Instruction

You have just purchased the most advanced and practical motorcycle storage solution on the market. Please check "Frame Tube List" and "Bolts List" before you start assembling. Follow assembly instruction from "STEP 1" to "STEP 7" in order.

The Bike Shield carries one year warranty against manufacturing defects in materials and workmanship. The Bike Shield is supposed to be fixed on the ground using the cross plate and anchor bolts so that it prevents The Bike Shield from falling down in high winds. It is also recommended to place The Bike Shield against the wall. Under customer's responsibility, The Bike Shield has to be secured to prevent any accident caused by strong wind, heavy snow or other natural disasters. Warranty does not cover defects or damages caused by accidents, alteration, improper installation, fire, earthquake, flood, lightning, storm, and other natural disasters.

- Frame Tube List -

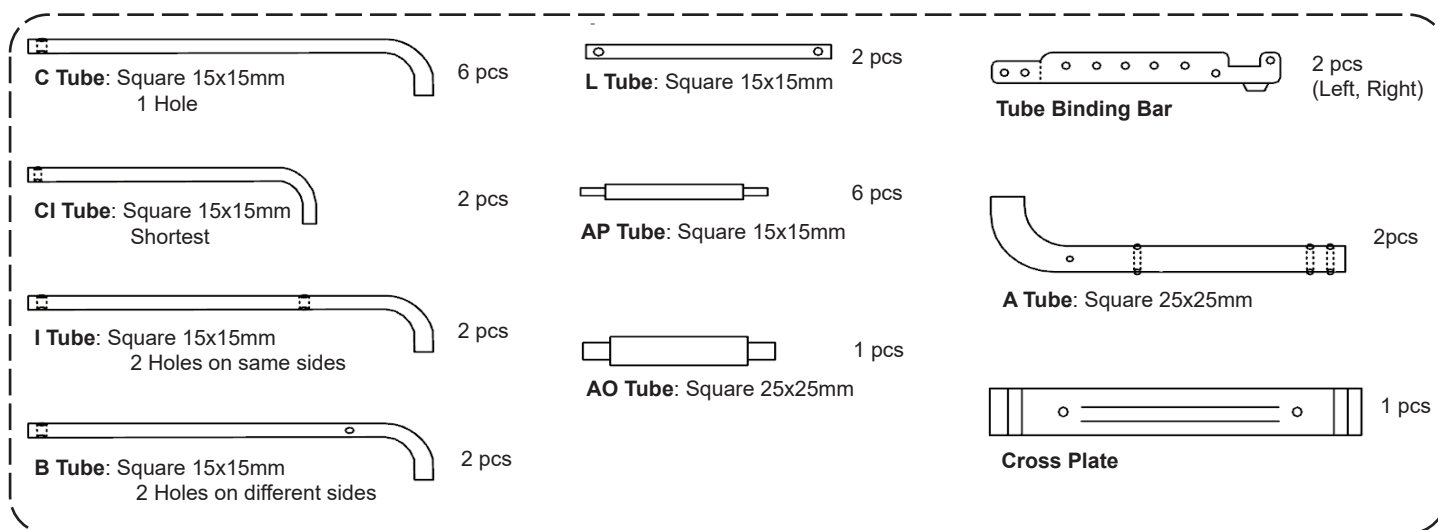

- Bolts List -

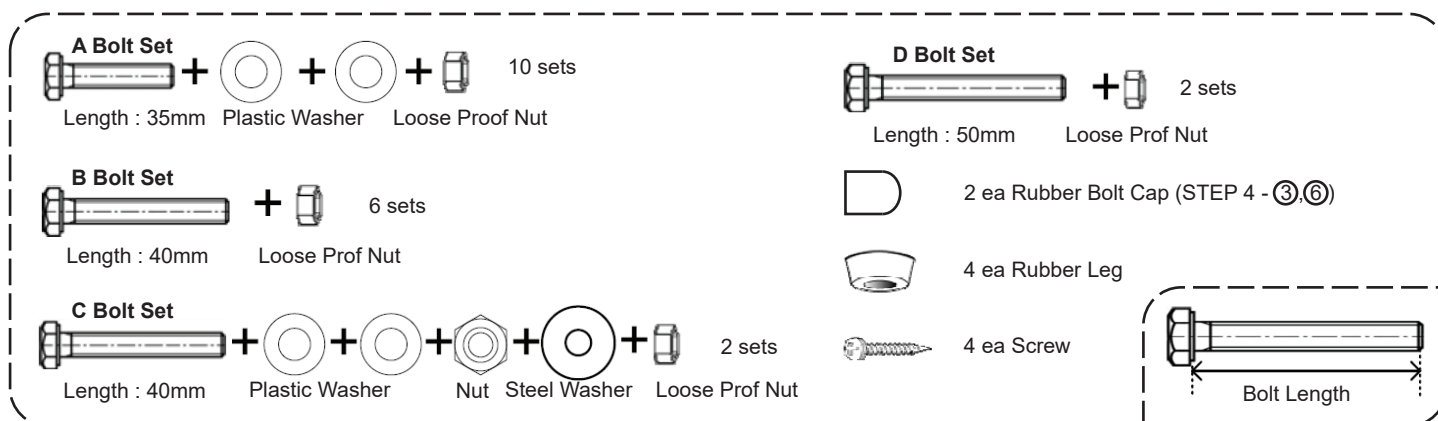

* During the assembly, please be careful of the sharp area like the edge of Cross Plate. Screwdriver and 10 mm (13/32 inch) spanner tools required to assemble The Bike Shield.

► The Bike Shield assembly video at <http://thebikeshield.com/assemblyinstruction.php>

The Bike Shield has to be secured to the ground.



The Bike Shield Frame assembly

- STEP 1 -

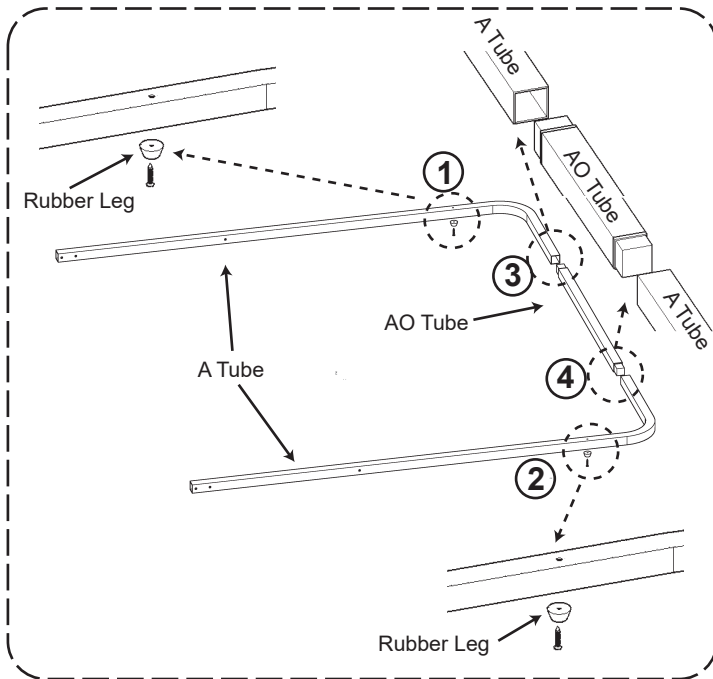

- STEP 2 -

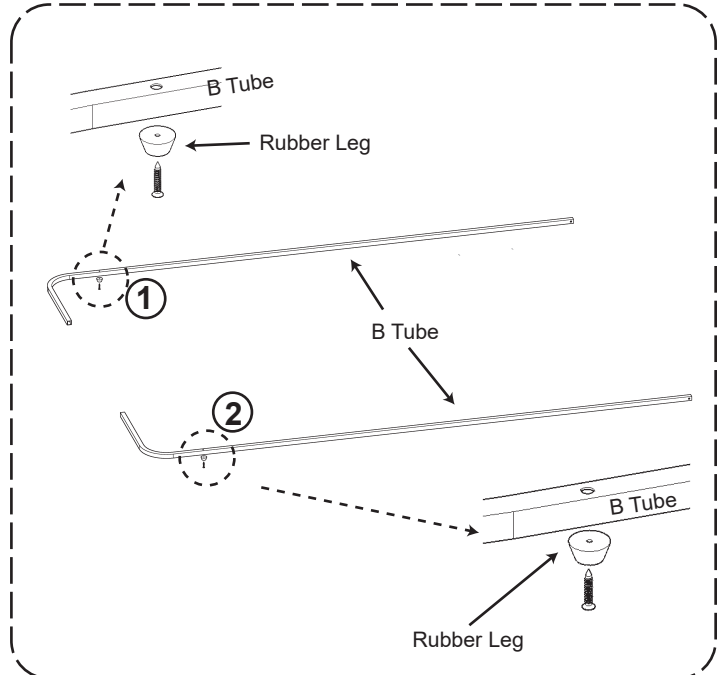

- ①,② Screw up Rubber Leg into A Tube.
 - ③,④ Connect AO Tube with two A Tube (right and left side).
- * Use rubber or wooden hammer to connect Tubes.

- ①,② Screw up Rubber Leg into B Tube.

- STEP 3 -

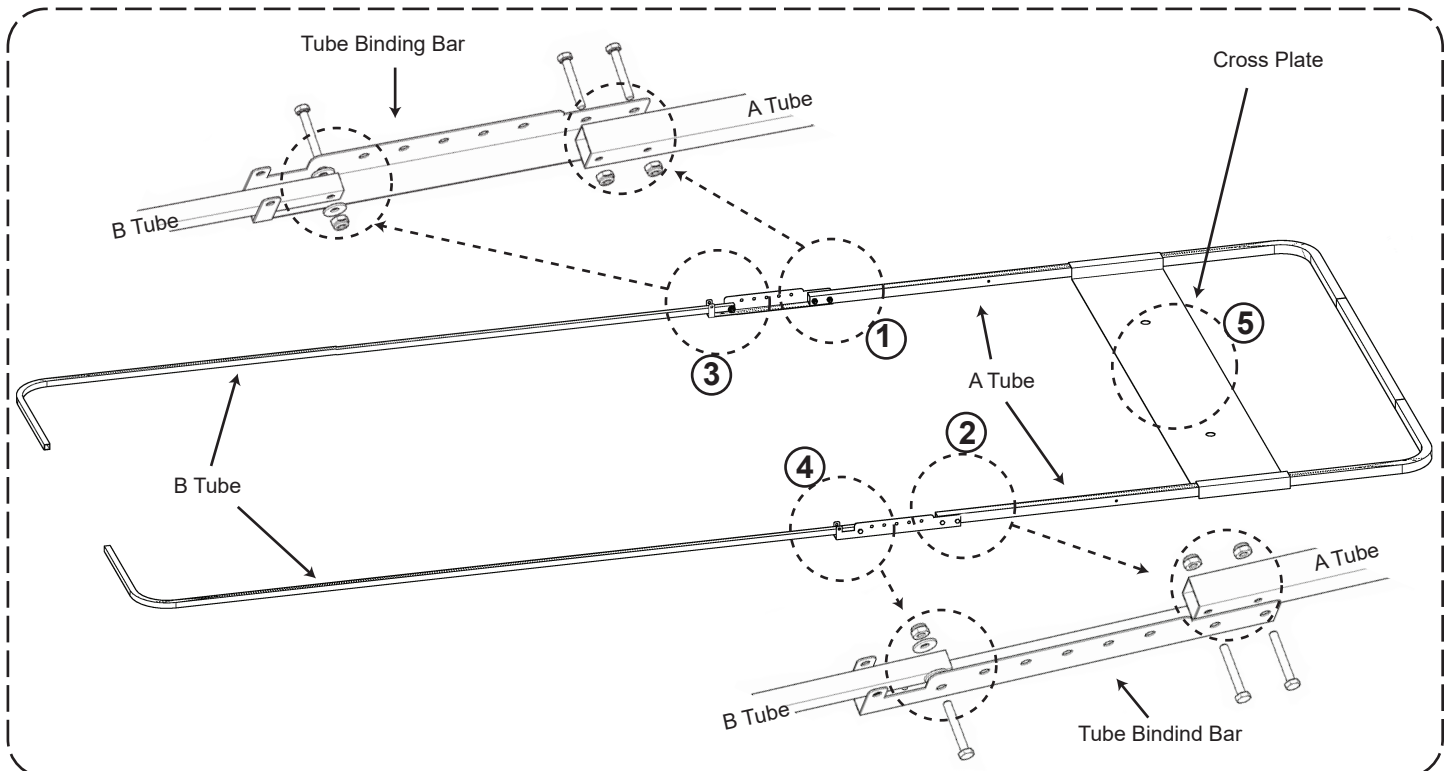

* All bolts should be inserted from outside to inside of The Bike Shield.

- ①,② Assemble A Tube with Tube Binding Bar using B Bolt Set.
- ③,④ Assemble B Tube with Tube Binding Bar using A Bolt Set.
- ⑤ Put Cross Plate on A Tube. Cross Plate has two holes for anchor bolts, fixing to the floor.



The Bike Shield Frame assembly

- STEP 4 -

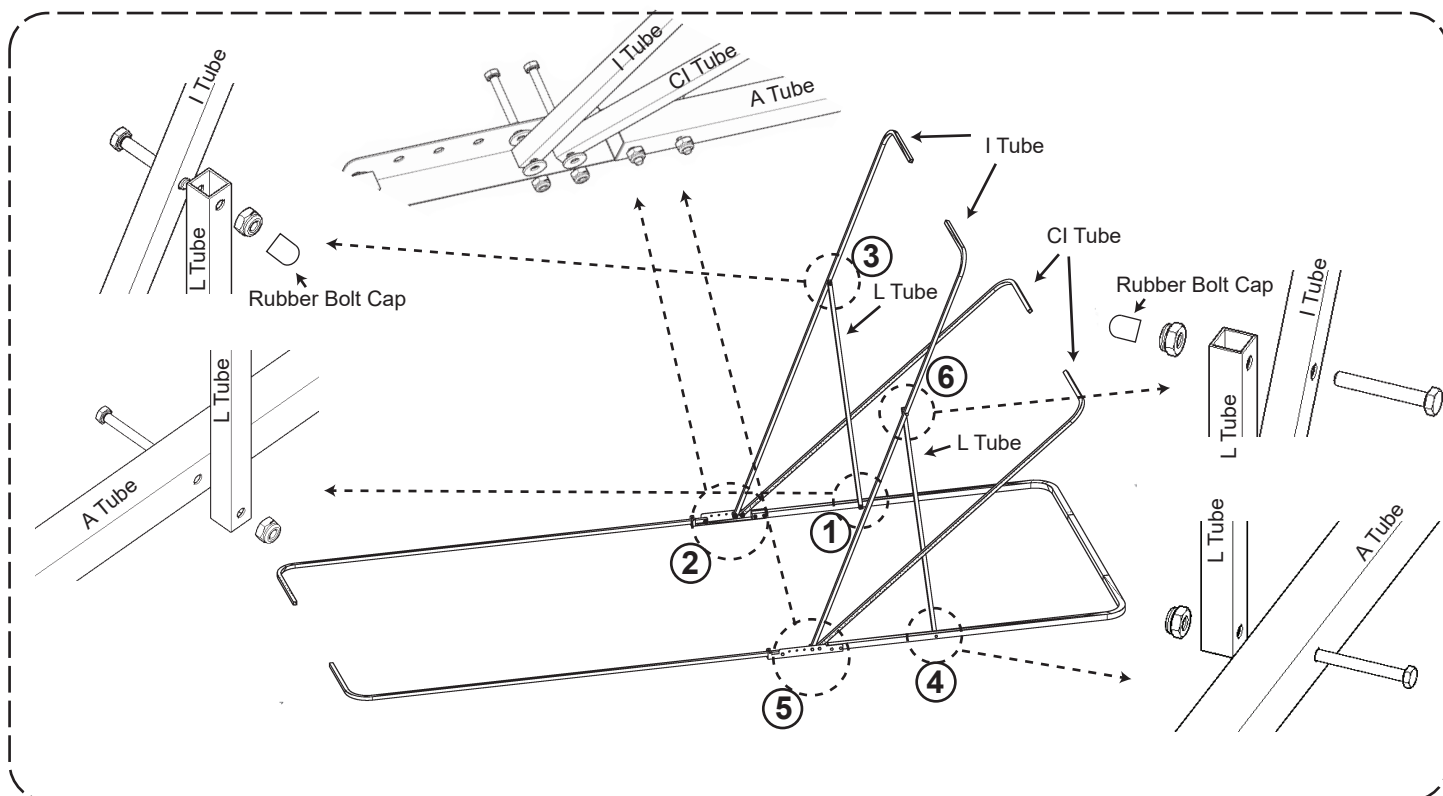

* All bolts should be inserted from outside to inside of The Bike Shield.

- ①,④ Assemble L Tube with A Tube using D Bolt Set.
- ②,⑤ Assemble CI Tube and I Tube with Tube Binding Bar using A Bolt Set.
- ③,⑥ Assemble I Tube with L Tube using B Bolt Set and assemble Rubber Bolt Cap.

- STEP 5 -

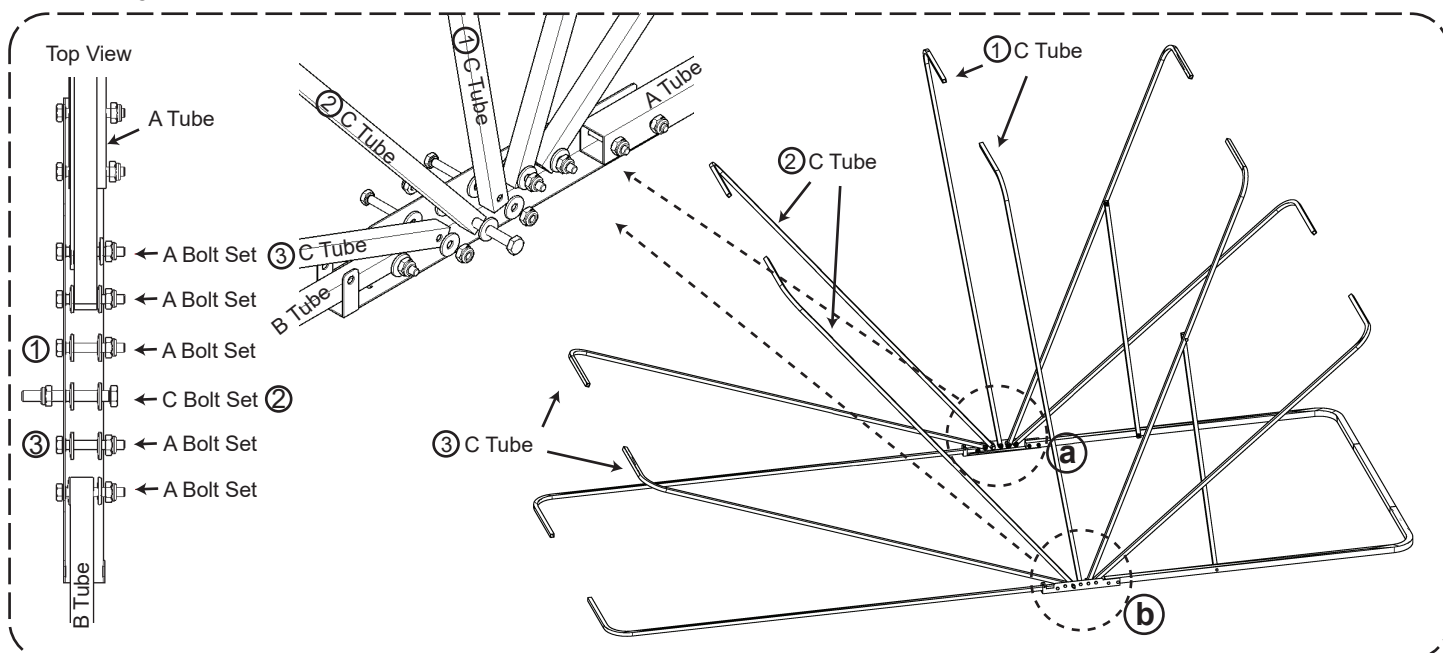

- a) Assemble three ①,②,③ C Tubes on the left side into Tube Binding Bar.
 - b) Assemble three ①,②,③ C Tubes on the right side into Tube Binding Bar.
- Use A Bolt Set to assemble ①,③ C Tubes. Bolts should be inserted from **outside to inside** of The Bike Shield.
- Use C Bolt Set to assemble ② C Tube. Bolts should be inserted from **inside to outside** of The Bike Shield.

* Do not assemble AP Tubes. AP Tubes will be assembled on the next STEP.



The Bike Shield Cover assembly

- STEP 6 -

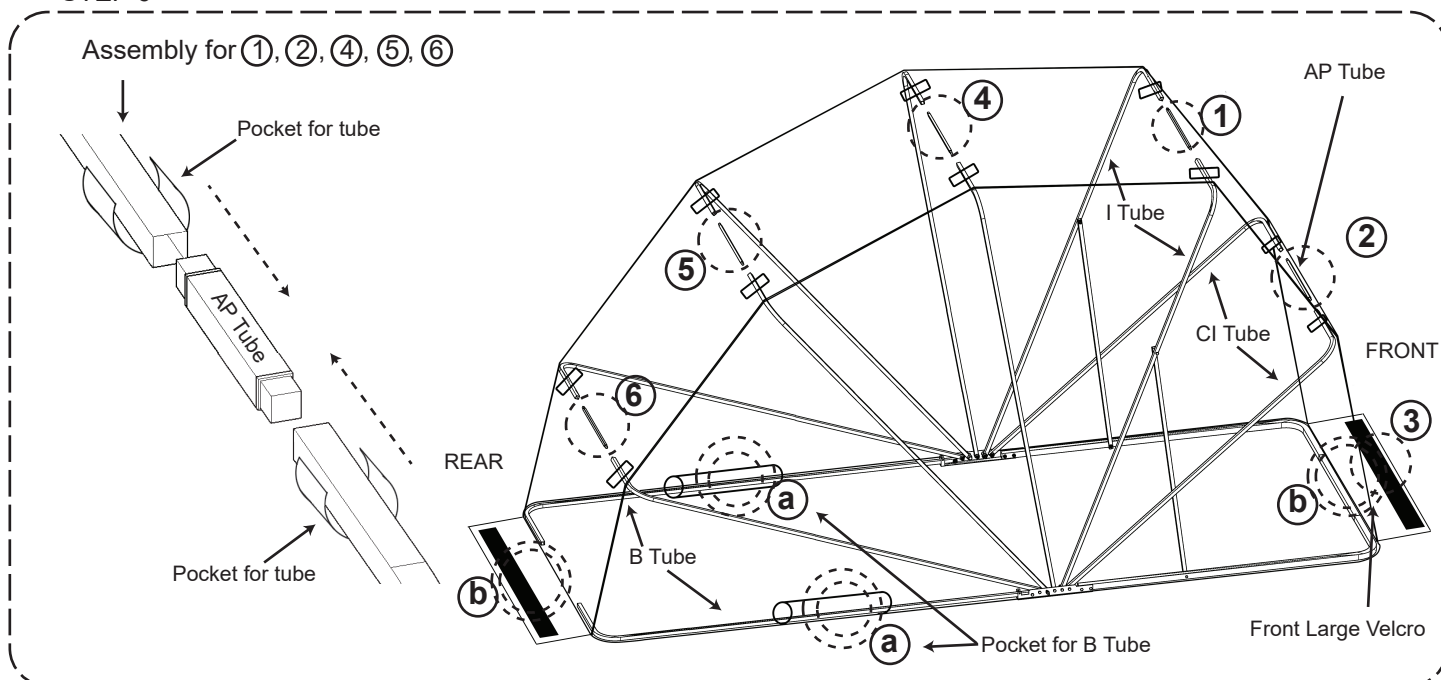

- (a) Identify front and rear side of the cover. Cover's **rear side** - Look up the position of two pockets for B Tube as shown.
- (b) "FRONT" and "REAR" are stamped on each side.
- (1) Put I Tube through pocket and connect to AP Tube with both side of I Tube.
- (2) Put CI Tube through pocket and connect to AP Tube with both side of CI Tube.
- (3) Start by pulling the **front side** Large Velcro flap under the AO Tube and attaching together.
- (4), (5), (6) Put each pair of C Tube through left and right side of pockets and connect with each AP Tube.

- STEP 7 -

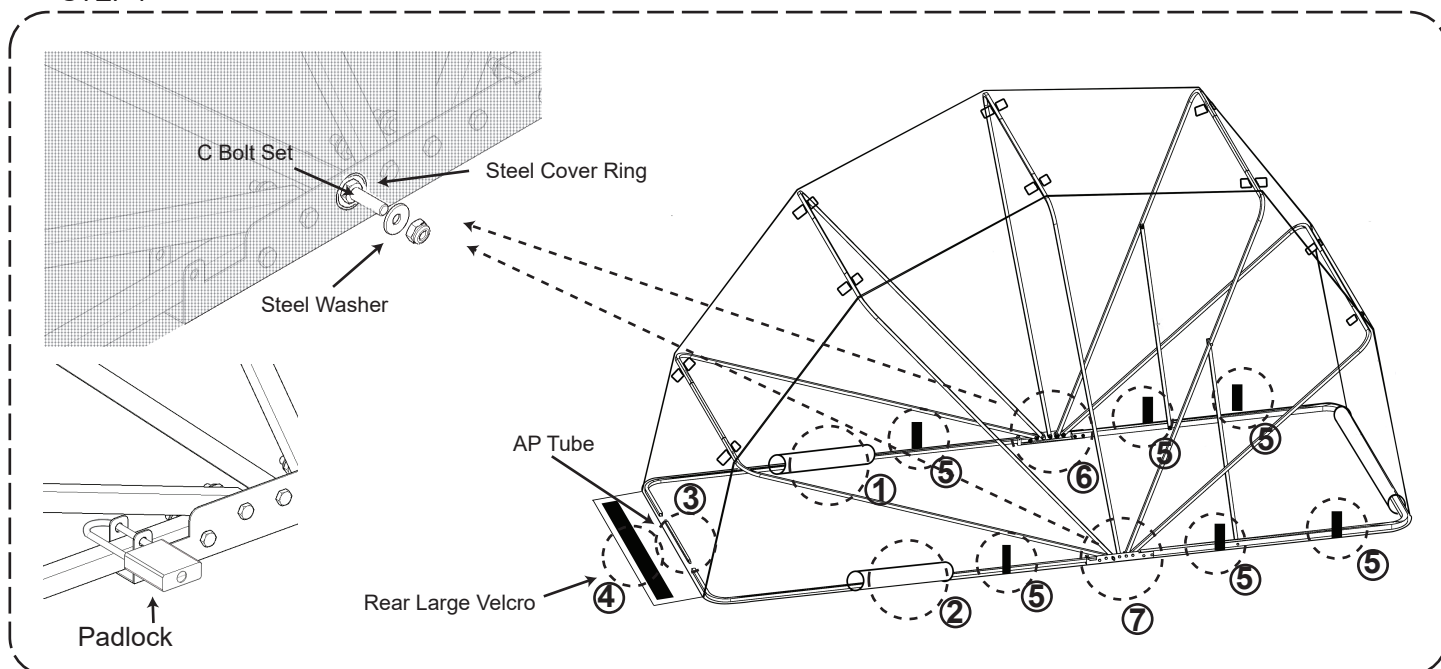

- (1), (2) Put B Tube through pockets on left and right side of cover.
- (3) Assemble AP Tube with both side of the B Tube.
- (4) Pull the rear side Large Velcro flap under the rear side of AP Tube and B Tube, then attach Large Velcro flap together.
- (5) Attach Velcro straps.
- (6), (7) Insert the Steel Cover Ring to the C Bolt Set, insert Steel Washer and fasten loose proof nut.

* Adjust tension with the front and rear Velcro flaps as well as the side Velcro straps to fit cover properly on the frame.

* You can use Padlock on the right or the left side of Tube Binding Bar.

* Padlock dimensions: <http://thebikeshield.com/assemblyinstruction.php>